

Metro line 11 - "Mairie des Lilas" station

Creation of 2 new secondary accesses

2015 - 2016



FRANCE - Les Lilas

Client

RATP

Owner

RATP

Highlights

2 complex 3D numerical models

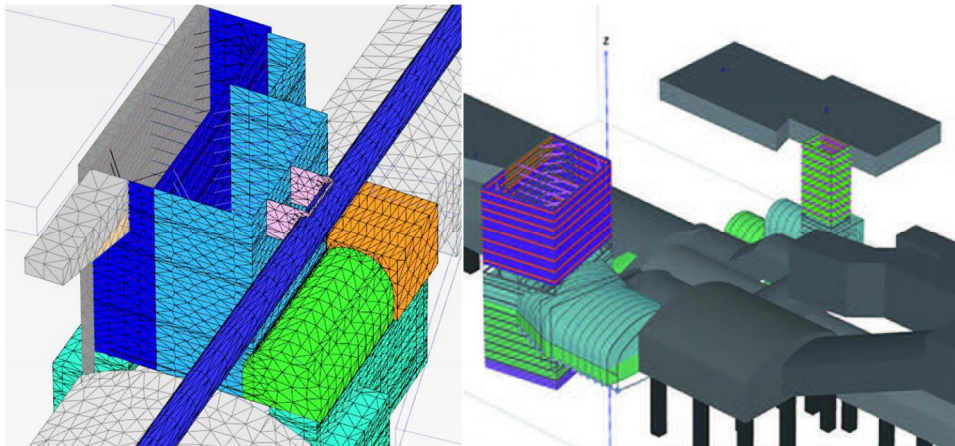

The Project

As part of the extension of line 11 of the Paris Metro to Rosny-Bois-Perrier, new secondary accesses have to be provided at Mairie des Lilas station, opened in 1937.

The works consist in creating lined shafts from groundlevel, from which galleries will be excavated to intersect the existing structures (ticket hall, connecting passages, underground station).

Key features

- Definition of the phasing of the works,
- Checking of the temporary support of the structures,
- Assessment of the effects of the construction of the new accesses on the existing underground structures as well as on the surface buildings and roads,
- Definition of the monitoring system

Our Services

The study had many challenges and objectives, set out by Paris transport authority RATP: define the phasing of the works, check the temporary support of the structures, assess the effects of the construction of the new accesses on the existing underground structures (Mairie des Lilas station and the line 11 tunnel) as well as on the surface buildings and roads, and lastly define a monitoring system.

Given the geometry of the structures, a three-dimensional numerical approach appeared to be essential in order to investigate correctly the complexity of the soil-structure interactions between the structures to be built and the existing structures, and consequently to be able to deal with the various issues mentioned above.

Two complex 3D numerical models were built, one for each access. They were used for detailed simulation of the works phasing and to design, during the RFP phase, the monitoring system that will be installed for application of the interactive design method during works execution.